

GENERAL NOTES

1. THE LOCATION OF THE EXISTING UTILITIES AS SHOWN ON THE PLANS ARE APPROXIMATE AND ARE INTENDED ONLY TO ADVISE THE CONTRACTOR OF THEIR PRESENCE. THE CONTRACTOR IS SOLELY RESPONSIBLE FOR DETERMINING THE ACTUAL LOCATIONS OF ALL EXISTING UTILITIES. CALL "DIG SAFE" (1-888-344-7233) FOR FIELD LOCATIONS OF ALL EXISTING UTILITIES. IN ADDITION, THE CONTRACTOR SHALL CONTACT THE ROWLEY WATER DEPARTMENT FOR WATER LINE LOCATIONS.
2. THE CONTRACTOR SHALL MAKE EVERY EFFORT NOT TO DISTURB THE EXISTING WATER SYSTEM. NO ADDITIONAL PAYMENT SHALL BE MADE FOR DAMAGE CREATED AT THE CONVENIENCE OF THE CONTRACTOR.
3. ALL AREAS DISTURBED DURING CONSTRUCTION SHALL BE RETURNED TO EQUAL OR BETTER THAN PRIOR CONDITION BY THE CONTRACTOR.
4. BASE MAP INFORMATION BASED UPON SITE PLANS BY WESTON & SAMPSON, INC. DATED JUNE 2012, INFORMATION PROVIDED BY THE ROWLEY CONSERVATION COMMISSION, AND UPON FIELD VERIFICATION CONDUCTED BY TATA & HOWARD, INC. IN JULY 2018 AND CONFIRMATION BY THE ROWLEY WATER DEPARTMENT IN JUNE 2023.
5. AREAS WITHIN THE 100-FOOT BUFFER ZONE OF THE BORDERING VEGETATED WETLAND ARE SUBJECT TO A DETERMINATION OF APPLICABILITY ISSUED BY THE ROWLEY CONSERVATION COMMISSION. SEE CONTRACT DOCUMENTS FOR ADDITIONAL INFORMATION.
6. CONTRACTOR SHALL COORDINATE WITH THE ROWLEY WATER DEPARTMENT FOR ACCESS TO THE SITE.
7. THE CONTRACTOR IS FULLY RESPONSIBLE FOR THE FURNISHING, INSTALLATION, MAINTENANCE, AND REPAIR OF ALL EROSION CONTROL DEVICES ON SITE, REGARDLESS OF WHETHER THE MEASURES ARE SPECIFIED IN THE DETERMINATION OF APPLICABILITY OR IN THE CONTRACT DOCUMENTS. ALL EROSION CONTROL DEVICES SHALL BE REGULARLY INSPECTED. ANY SEDIMENTS REMOVED FROM THE CONTROL DEVICES SHALL BE LEGALLY DISPOSED OF OFF SITE.
8. NO MATERIALS SHALL BE DISPOSED OF INTO ANY WETLANDS OR EXISTING DRAINAGE SYSTEMS.
9. THE WORK AREA IS LOCATED WITHIN THE 100-FOOT BUFFER ZONE TO THE WETLANDS AND THE ZONE 1 OF THE WELLS. ANY REFUELING AND MAINTENANCE OF CONSTRUCTION VEHICLES AND EQUIPMENT SHALL TAKE PLACE OFF SITE OUTSIDE OF THESE RESOURCE AREAS.
10. EXISTING VALVES SHALL ONLY BE OPERATED BY THE ROWLEY WATER DEPARTMENT.
11. IF NECESSARY, SUPPLEMENTAL EROSION CONTROLS (COMPOST OR BARK MULCH SOCKS, STRAW WATTLES, OR STRAW BALES) SHALL BE UTILIZED TO SLOW VELOCITIES, DIRECT DISCHARGE WATERS AWAY FROM THE WELL AREAS, AND PREVENT EROSION AND SEDIMENT TRANSPORT INTO UNDISTURBED AREAS, WETLAND RESOURCE AREAS, PUBLIC ROADWAYS, AND ADJUTING PROPERTIES. THE ADDITIONAL EROSION CONTROL MEASURES SHALL BE THE FULL RESPONSIBILITY OF THE CONTRACTOR AND SHALL BE PROVIDED AT NO ADDITIONAL COST TO THE OWNER.

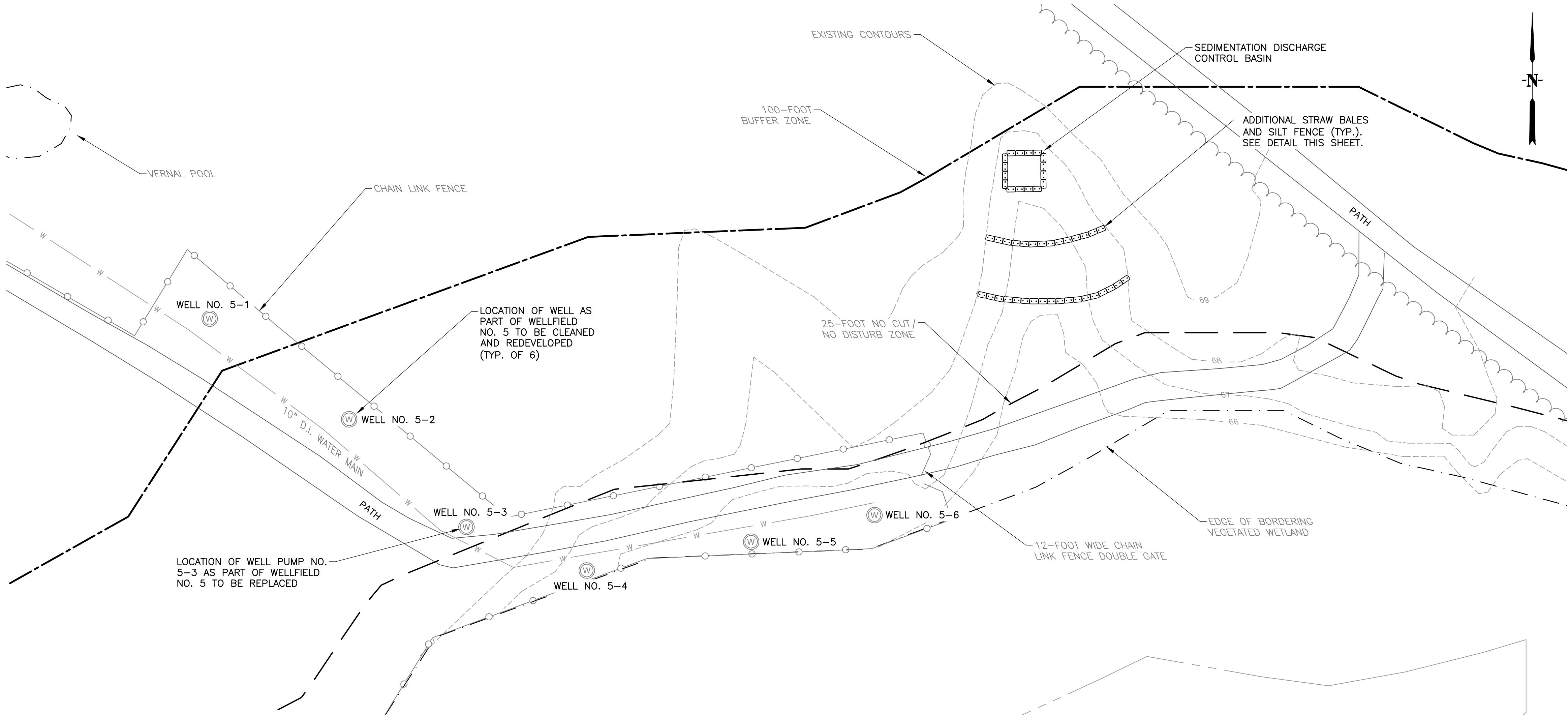

WELLFIELD NO. 5 SITE PLAN

SCALE: 1" = 20'

ABBREVIATIONS

A.C.	ASBESTOS CEMENT
DIA.	DIAMETER
EL.	ELEVATION
EX.	EXISTING
TYP.	TYPICAL

LEGEND

EXISTING	DESCRIPTION	PROPOSED
W	WATER MAIN	
○	HYDRANT	
—○—	FENCE	
~~~~~	TREE LINE	
- - - - -	WETLANDS	
=====	100' BUFFER ZONE	
- - - - -	25' NO CUT/NO DISTURB ZONE	
	STRAW BALE	

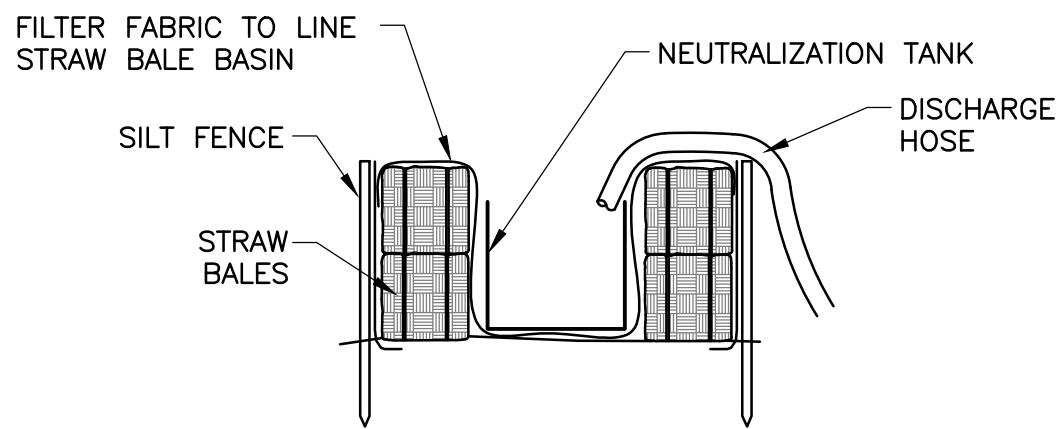

SEDIMENTATION DISCHARGE CONTROL BASIN

SCALE: NONE

NOTES:

1. STRAW BALES SHALL BE STACKED 1 OR 2 ROWS HIGH AS REQUIRED TO MITIGATE THE FLOW.
2. THE BASIN SHALL BE SIZED TO FILTER THE FLOW BEING DISCHARGED TO THE BASIN.

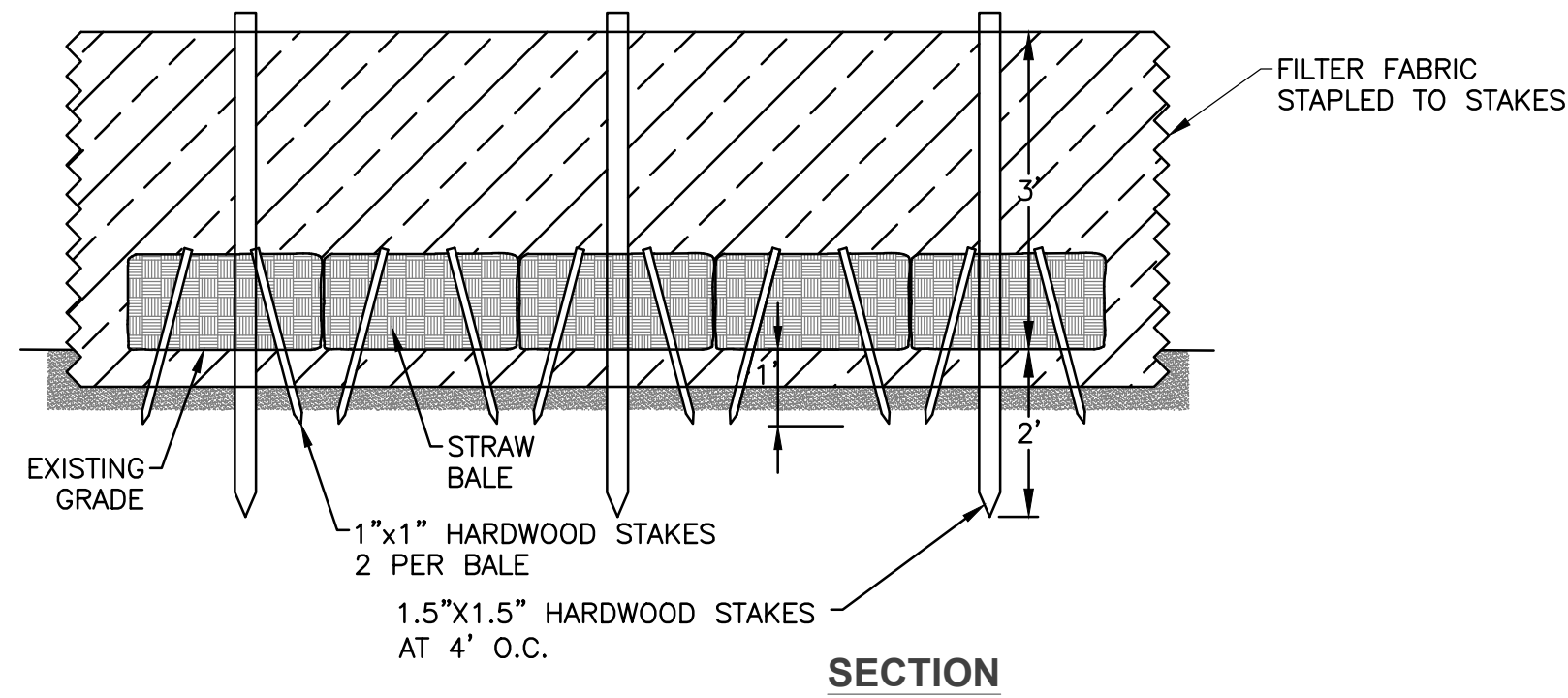

SILT FENCE/STRAW BALE EROSION CONTROL

SCALE: NONE

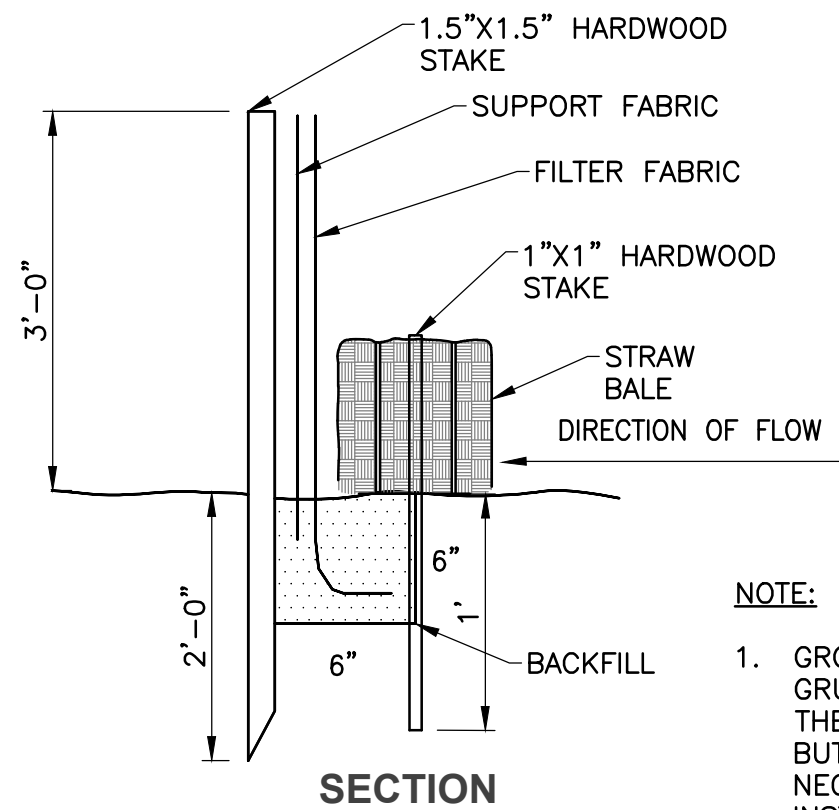

NOTE:

1. GROUND SHALL BE CLEARED AND GRUBBED AT THE LOCATIONS OF THE PROPOSED EROSION CONTROL, BUT NOT OUTSIDE THE FOOTPRINT NECESSARY FOR PROPER INSTALLATION.

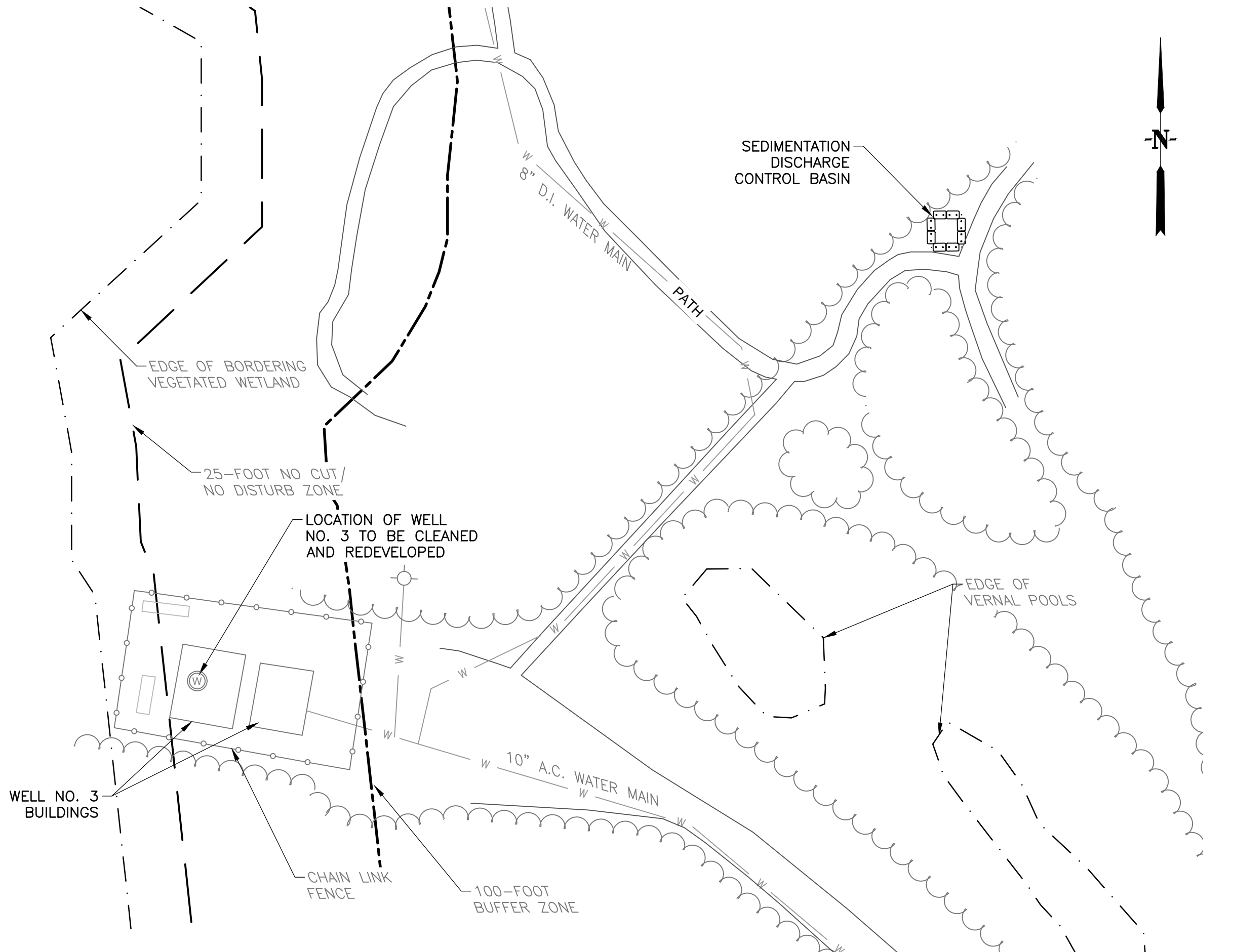

WELL NO. 3 SITE PLAN

SCALE: 1" = 40'

ROWLEY WATER DEPARTMENT  
ROWLEY, MASSACHUSETTS

WELL NO. 3 AND WELLFIELD NO. 5  
CLEANING AND REDEVELOPMENT

SITE PLANS

Drawn By: KEC  
Checked By: JWG  
Approved By: RPN

THIS DOCUMENT IS THE PROPERTY OF TATA & HOWARD, INC. AND ITS CLIENT.  
REPRODUCTION OR MODIFICATION WITHOUT WRITTEN CONSENT IS PROHIBITED.

Description  
Date  
Rev.

RDA REVIEW  
SUBMITTAL  
NOT FOR  
CONSTRUCTION



TATA & HOWARD

T&H NO.: 7399  
DATE: JUNE 2023  
SCALE: AS NOTED

FIG. NO. 5