

ROWLEY, MASS.

Site Plan in

Hayes Engineering, Inc.
Civil Engineers & Land Surveyors
603 Salem Street
Wakefield, MA 01880

Telephone: 781.246.2800
Facsimile: 781.246.7596
www.hayeseng.com

Scale: 1" = 20' 0' 10' 20' 40' 60'

May 16, 2023

#57 Saunders Lane Showing Proposed Plantings

NOTES:

1. REFER TO HAYES ENGINEERING, INC. DOCUMENT "BUFFER MITIGATION SPECIFICATIONS, #57 SAUNDERS LANE, ROWLEY, MA" DATED 5/16/23.
2. THE SITE DETAILS DEPICTED HEREON ARE FROM A PLAN ENTITLED "RECORD CONDITIONS PLANS" PREPARED BY MERIDIAN ENGINEERING, INC. DATED DECEMBER 4, 2001. HAYES ENGINEERING CONDUCTED AN ACTUAL ON-THE-GROUND FIELD SURVEY TO TIE INTO SAID PLAN ON MAY 11, 2023.
3. PLANTED 25' BUFFER/NO CUT AREA TO BE PERPETUALLY KEPT IN A NATURALIZED, UN-MOWED CONDITION, EXCEPT FOR THE DOG PEN WHICH IS PROPOSED TO REMAIN IN PLACE.

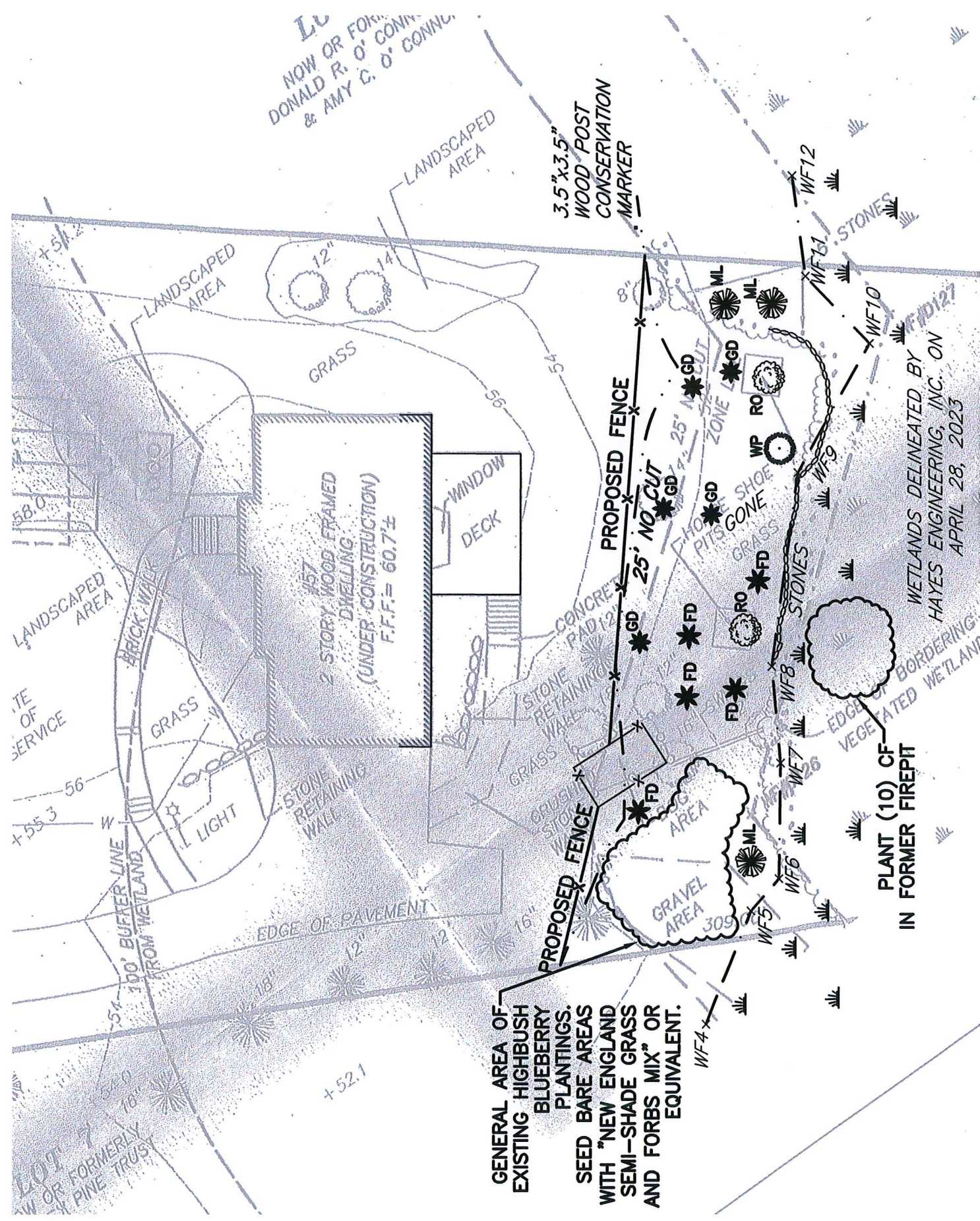

PLANTING LIST

SYMBOL	QUANTITY	BOTANICAL NAME	COMMON NAME
RO	2	QUERCUS RUBRA	RED OAK
WP	1	PINUS STROBUS	WHITE PINE
FD	5	CORNUS FLORIDA	FLOWERING DOGWOOD
GD	5	CORNUS RACEMOSA	GREY DOGWOOD
ML	3	KALMIA LATIFOLIA CAROL	MOUNTAIN LAUREL "CAROL"
CF	10	OSMUNDA CINNAMOMEA	CINNAMON FERN
-	-	-	N.E. SEMI-SHADE GRASS + FORBES MIX