

GENERAL NOTES

1. THE PURPOSE OF THIS PLAN IS TO SHOW THE AS-BUILT CONDITIONS OF THE DRIVEWAY, ASSOCIATED DRAINAGE AREAS, AND OTHER IMPROVEMENTS LEADING FROM WETHERSFIELD STREET TO THE TWO LEASED SOLAR ARRAY AREAS.
2. THIS PLAN DOES NOT SHOW THE ENTIRE AREA OWNED BY MAVEN REALTY TRUST.
3. THE VERTICAL DATUM USED IS NAVD 1988 BASED ON REDUNDANT NETWORK RTK CORRECTED GNSS OBSERVATIONS.
4. FLOOD INSURANCE RATE MAP COMMUNITY-PANEL NUMBER 250101 0256 G EFFECTIVE DATE: JULY 16, 2014. LEASE AREAS AND AS-BUILT AREA ARE IN A ZONE X, AREA OF MINIMAL FLOOD HAZARD.
5. WETLANDS DELINEATED AND FLAGGED BY NORSE ENVIRONMENTAL SERVICES, INC. OCT, NOV, AND DEC 2017 AS WELL AS JAN 2018.
6. OWNERS OF ADJOINING PROPERTIES ARE SHOWN ACCORDING TO CURRENT ASSESSOR'S MAPS.
7. UNLESS OTHERWISE NOTED DISTANCE AND ELEVATIONS ARE DEPICTED IN DECIMAL FEET.
8. SEE SHEET 2 OF 2 FOR LEGEND AND ABBREVIATIONS.

DEED REFERENCES:

- TO: THE MAVEN REVOCABLE TRUST
FROM: BARBARA A. BERKOWITZ
ESRD 21475/354 7-14-03
- TO: THE MAVEN REVOCABLE TRUST
FROM: BONNI BERKOWITZ
ESRD 34541/38 11-20-15
- TO: THE MAVEN REVOCABLE TRUST
FROM: TOWN OF ROWLEY
ESRD 34541/36 11-20-15

PLAN REFERENCES:

- 1) PLAN OF LAND, BERKOWITZ, 623 WETHERSFIELD STREET, ROWLEY, MA PREPARED FOR BONNIE BERKOWITZ PREPARED BY CAMMETT ENGINEERING, INC SCALE: 1"=40' DRAFT DATE 11-10-19 CAMMETT JOB #08062PL
- 2) PLAN OF LOTS, DEFINITIVE SUBDIVISION AT WHISPERING PINES IN GEORGETOWN, MA PREPARED FOR WARREN STREET REALTY TRUST PREPARED BY ATLANTIC ENGINEERING & SURVEY CONSULTANTS INC. ESRD PLAN BOOK 370 PLAN 27 DATED: REVISED 07-12-02
- 3) PLAN OF LAND IN ROWLEY, MASS. FOR JHOSET E. COSTA PREPARED BY NORTH SHORE ENGINEERING ESRD PLAN BOOK 272 PLAN 63 11-21-90
- 4) PLAN OF LAND AT BROOK STREET IN ROWLEY, MASSACHUSETTS PREPARED FOR THE BYFIELD CO. LTD. PREPARED BY ATLANTIC ENGINEERING & SURVEY CONSULTANTS INC. ESRD PLAN BOOK 338 PLAN 61 UPDATED 10-14-98
- 5) PLAN SHOWING DIVISION OF LAND IN ROWLEY, MASS. PREPARED FOR THE VIRGO TRUST PREPARED BY ENVIRONMENTAL ENGINEERS CORP. ESRD PLAN BOOK 159 PLAN 12 11-26-79

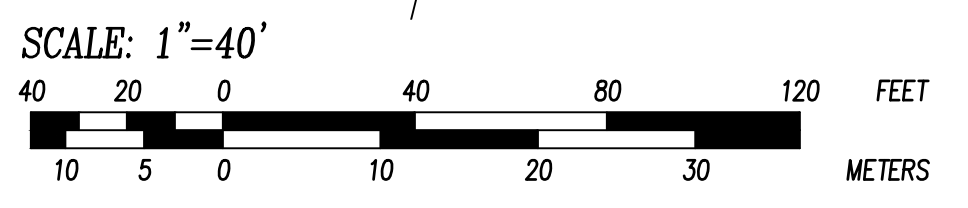

FOR REGISTRY USE ONLY

G&M2 CAMMETT

6 CHESTNUT STREET, AMESBURY, MA.
Phone: (978) 388-2157
CONSULTING ENGINEERS & LAND SURVEYORS SINCE 1988
www.gm2inc.com

Sheet Title:

AS-BUILT

to Accompany
Application for COC

Project Title:

Rowley Solar

623 Wethersfield Street
Rowley, MA 01969

Applicant/Owner:

PowerFund One

10250 Constellation Blvd.
Suite 100
Los Angeles, CA 90067

REVISION BLOCK

NO.	DATE	DESC	BY

Date: *12/21/2022*

PROJ MGR: J. SALVAGGIO
FIELD: E. EDWARDS, J. SALVAGGIO
DESIGN: J. SALVAGGIO
DRAWN: J. SALVAGGIO
CHECKED: D. HAMEL
DATE: 12/21/2022
FILE: 60117 AB.DWG
FBK:
JOB #: 60117

SHEET 1 of 2

LEGEND:

- EXISTING CONTOURS
- EXISTING CONTOURS
- WETLAND BOUNDARY
- WETLAND FLAG
- WATER LINE
- OVERHEAD WIRE
- CHAIN LINKED FENCE
- WOOD FENCE
- TREE LINE
- STONE WALL
- DRAINAGE LINE
- FLARED END SECTION
- UNDERGROUND ELECTRIC LINE (LOCATION PROVIDED BY CONTRACTOR)
- EDGE OF PAVEMENT
- EDGE OF GRAVEL
- BUILDING
- IRON ROD
- DRILL HOLE
- MAIL BOX
- WELL
- ROCK
- AREA OF SOLAR ARRAY
- RIPRAP
- CONCRETE
- LIGHT POLE
- GUY WIRE
- UTILITY POLE
- FIRE HYDRANT
- TAX MAP AND PARCEL ID
- DECIDUOUS TREE
- CONIFEROUS TREE

ABBREVIATIONS:

- EXIST. EXISTING
- ELEV. ELEVATION
- TYP. TYPICAL
- FND. FOUND
- INV. INVERT ELEVATION
- BVW. BORDERING VEGETATIVE WETLANDS
- IVW. ISOLATED VEGETATIVE WETLANDS
- POB. POINT OF BEGINNING
- N/F. NOW OR FORMERLY
- CPP. CORRUGATED PLASTIC PIPE
- HDPE. HIGH DENSITY POLYETHYLENE
- TRANS. TRANSFORMER
- ELEC. ELECTRICAL BOX

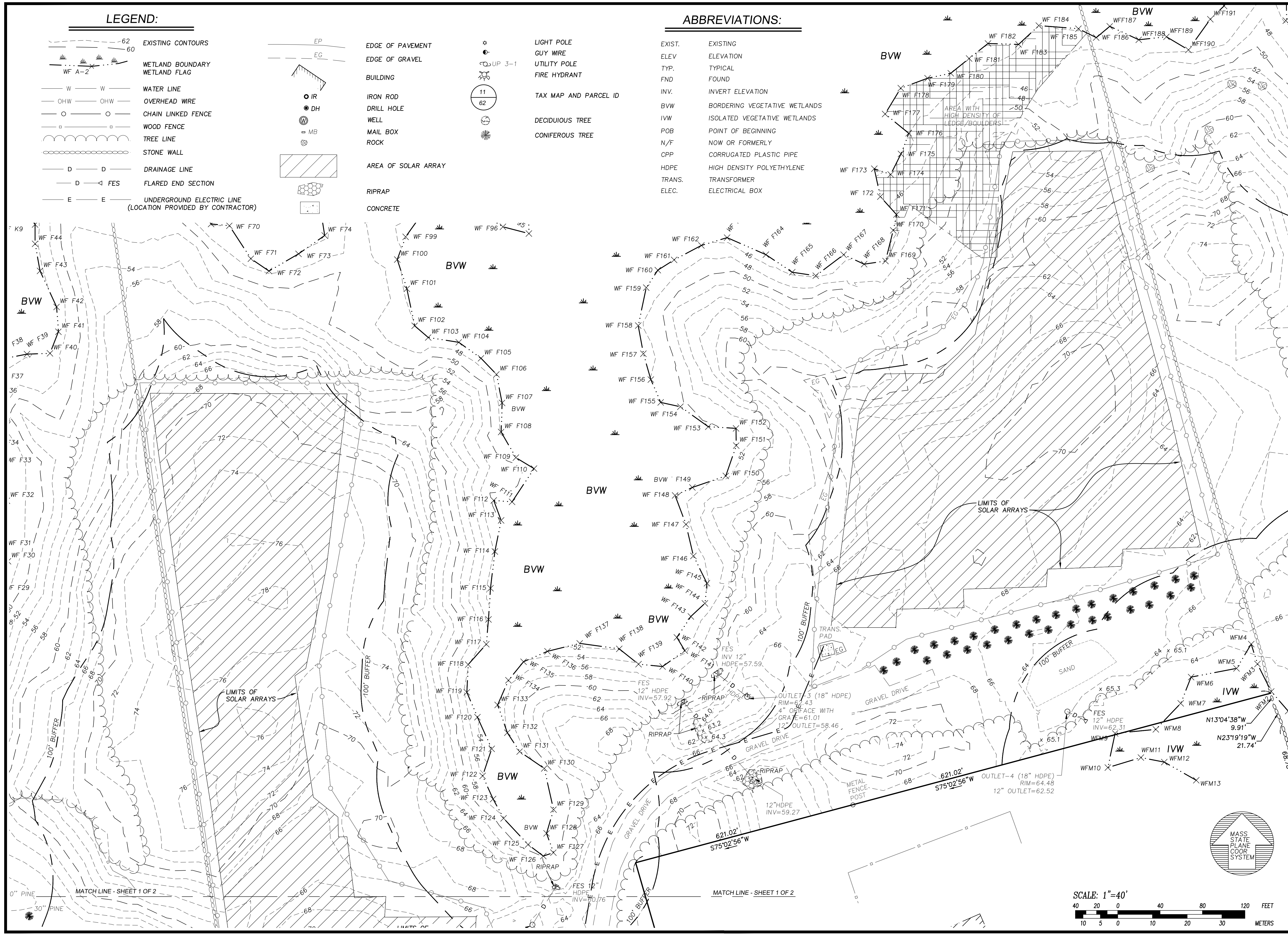

FOR REGISTRY USE ONLY

GMP
CAMMETT

6 CHESTNUT STREET, AMESBURY, MA.
Phone: (978) 388-2157
CONSULTING ENGINEERS &
LAND SURVEYORS SINCE 1988
www.gm2inc.com

Sheet Title:

AS-BUILT

to Accompany
Application for COC

Project Title:

Rowley Solar

623 Wethersfield Street
Rowley, MA 01969

Applicant/Owner:

PowerFund One

10250 Constellation Blvd.
Suite 100
Los Angeles, CA 90067

REVISION BLOCK

NO.	DATE	DESC	BY

MASSACHUSETTS REGISTERED PROFESSIONAL LAND SURVEYOR

JANE F. SALVAGGIO
No. 56591

J. Salvaggio
Date: 12/21/2022

Date:

PROJ. MGR.: J. SALVAGGIO
FIELD: E. EDWARDS, J. SALVAGGIO
DESIGN: J. SALVAGGIO
DRAWN: J. SALVAGGIO
CHECKED: D. HAMEL
DATE: 12/21/2022
FILE: 60117 AB.DWG
FBK:
JOB #: 60117

