

Forms

[RCC Notice of Intent Permit Filing Checklist](#)

[Notice of Intent \(NOI\) WPA Form 3](#)

[Wetland Fee Transmittal Form](#)

[Town of Rowley Wetlands Protection Bylaw Fee Worksheet](#)

[Copies of Filing Fee Checks](#)

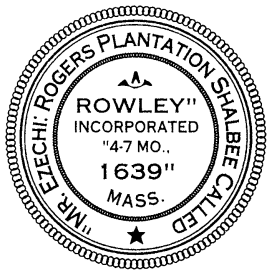

Town of Rowley

Conservation Commission

Phone: (978) 948-2330 Fax: (978) 948-7196

Conservation@townofrowley.org

NOTICE OF INTENT PERMIT FILING CHECKLIST

Send the following by certified mail, return receipt requested, or hand deliver to:

Rowley Conservation Commission, PO Box 24, OR 39 Central Street, Room #4, Rowley MA 01969

- Two copies of the Submittal Package appropriately collated including:
 - Completed WPA Form 3, 4, & 4A (one set with original signatures)
 - Copy of the check made out to the Commonwealth of Massachusetts
 - Copy of the check made out to the Town of Rowley
 - Section of U.S. Geologic Survey (USGS) quadrangle locating site
 - Copy of the Certified Abutters List with parcel map from the Rowley Assessors Office
 - Copy of the Abutter Notification letter
 - Stamped, signed and dated site plan prepared by professional engineer or land surveyor
- Check made out to the Town of Rowley (may include Bylaw fee amount)
- One copy of Wetland Bylaw Fee Calculation Form
- One copy of NOI Wetland Fee Transmittal Form, pages 1 & 2
- One electronic submission in "PDF" form of all application documents and plans.

Send the following by certified mail, return receipt requested or hand deliver to:

DEP NERO, Wetlands Div. 205B Lowell Street, Wilmington, MA 01887

- One copy of the Completed Application WPA Form 3, 4, & 4A including:
 - Attached site plan prepared by professional engineer or land surveyor
 - Section of U.S. Geologic Survey (USGS) quadrangle locating site
 - Copy of the check made out to the Town of Rowley
 - Copy of the check made out to the Commonwealth of Massachusetts
 - Copy of the Certified Abutters List with parcel map from the Rowley Assessors Office
 - Copy of the Abutter Notification letter
 - Copy of NOI Wetland Fee Transmittal Form, pages 1 & 2.

Send the following by certified mail, return receipt requested to:

Department of Environmental Protection, Box 4062, Boston, MA 02211

- Check made out to the Commonwealth of Massachusetts
- NOI Wetland Fee Transmittal Form, pages 1 & 2.

If more than 75 cubic yards of earth will be removed, an Earth Removal Application must be filed with the Board of Selectmen.

Revised 01/10/2022

Town Hall Annex • Room 4 • 39 Central Street • P O Box 24 • Rowley, MA 01969



Massachusetts Department of Environmental Protection
Bureau of Resource Protection - Wetlands

WPA Form 3 – Notice of Intent

Massachusetts Wetlands Protection Act M.G.L. c. 131, §40

Provided by MassDEP:

MassDEP File Number

Document Transaction Number

Rowley

City/Town

Important:

When filling out forms on the computer, use only the tab key to move your cursor - do not use the return key.



Note:
Before completing this form consult your local Conservation Commission regarding any municipal bylaw or ordinance.

A. General Information

1. Project Location (**Note:** electronic filers will click on button to locate project site):

<u>20 Central Street</u>	<u>Rowley</u>	<u>01969</u>
a. Street Address	b. City/Town	c. Zip Code
<u>Latitude and Longitude:</u>	<u>42.71689 N</u>	<u>70.87964 W</u>
<u>25</u>	d. Latitude	e. Longitude
f. Assessors Map/Plat Number	<u>7</u>	g. Parcel /Lot Number

2. Applicant:

<u>TRS Ox Brook Real Estate TRS Gerald N Fandetti, Trustee</u>	<u>TRS Ox Brook Real Estate TRS Gerald N Fandetti, Trustee</u>
a. First Name	b. Last Name
<u>350 Main Street</u>	
c. Organization	
<u>Cambridge</u>	<u>MA</u>
d. Street Address	f. State
e. City/Town	<u>02142-1017</u>
	g. Zip Code
<u>germno@icloud.com</u>	
h. Phone Number	i. Fax Number
	j. Email Address

3. Property owner (required if different from applicant): Check if more than one owner

<u></u>	<u></u>
a. First Name	b. Last Name
<u></u>	
c. Organization	
<u></u>	
d. Street Address	
<u></u>	<u></u>
e. City/Town	f. State
	g. Zip Code
<u></u>	
h. Phone Number	i. Fax Number
	j. Email address

4. Representative (if any):

<u>Michael</u>	<u>DeRosa</u>
a. First Name	b. Last Name
<u>DeRosa Environmental Consulting, Inc.</u>	
c. Company	
<u>PO Box 716</u>	
d. Street Address	
<u>Rowley</u>	<u>MA</u>
e. City/Town	f. State
	<u>01969</u>
<u>978-948-7717</u>	
h. Phone Number	i. Fax Number
	j. Email address

5. Total WPA Fee Paid (from NOI Wetland Fee Transmittal Form):

<u>\$165</u>	<u>\$70</u>	<u>\$95</u>
a. Total Fee Paid	b. State Fee Paid	c. City/Town Fee Paid



Massachusetts Department of Environmental Protection
Bureau of Resource Protection - Wetlands

WPA Form 3 – Notice of Intent

Massachusetts Wetlands Protection Act M.G.L. c. 131, §40

Provided by MassDEP:
MassDEP File Number
Document Transaction Number
Rowley
City/Town

A. General Information (continued)

6. General Project Description:

Proposed construction of a patio, implementation of a Restoration Plan and after the fact alteration within the buffer zone to inland bank

7a. Project Type Checklist: (Limited Project Types see Section A. 7b.)

- 1. Single Family Home
- 2. Residential Subdivision
- 3. Commercial/Industrial
- 4. Dock/Pier
- 5. Utilities
- 6. Coastal engineering Structure
- 7. Agriculture (e.g., cranberries, forestry)
- 8. Transportation
- 9. Other

7b. Is any portion of the proposed activity eligible to be treated as a limited project (including Ecological Restoration Limited Project) subject to 310 CMR 10.24 (coastal) or 310 CMR 10.53 (inland)?

- 1. Yes No If yes, describe which limited project applies to this project. (See 310 CMR 10.24 and 10.53 for a complete list and description of limited project types)

2. Limited Project Type

If the proposed activity is eligible to be treated as an Ecological Restoration Limited Project (310 CMR10.24(8), 310 CMR 10.53(4)), complete and attach Appendix A: Ecological Restoration Limited Project Checklist and Signed Certification.

8. Property recorded at the Registry of Deeds for:

Essex	
a. County	b. Certificate # (if registered land)
31498	0064
c. Book	d. Page Number

B. Buffer Zone & Resource Area Impacts (temporary & permanent)

- 1. Buffer Zone Only – Check if the project is located only in the Buffer Zone of a Bordering Vegetated Wetland, Inland Bank, or Coastal Resource Area.
- 2. Inland Resource Areas (see 310 CMR 10.54-10.58; if not applicable, go to Section B.3, Coastal Resource Areas).

Check all that apply below. Attach narrative and any supporting documentation describing how the project will meet all performance standards for each of the resource areas altered, including standards requiring consideration of alternative project design or location.



Massachusetts Department of Environmental Protection
Bureau of Resource Protection - Wetlands

WPA Form 3 – Notice of Intent

Massachusetts Wetlands Protection Act M.G.L. c. 131, §40

Provided by MassDEP:

MassDEP File Number

Document Transaction Number

Rowley

City/Town

B. Buffer Zone & Resource Area Impacts (temporary & permanent) (cont'd)

For all projects affecting other Resource Areas, please attach a narrative explaining how the resource area was delineated.

Resource Area	Size of Proposed Alteration	Proposed Replacement (if any)
a. <input type="checkbox"/> Bank	1. linear feet	2. linear feet
b. <input type="checkbox"/> Bordering Vegetated Wetland	1. square feet	2. square feet
c. <input type="checkbox"/> Land Under Waterbodies and Waterways	1. square feet	2. square feet
	3. cubic yards dredged	

Resource Area	Size of Proposed Alteration	Proposed Replacement (if any)
d. <input type="checkbox"/> Bordering Land Subject to Flooding	1. square feet	2. square feet
	3. cubic feet of flood storage lost	4. cubic feet replaced
e. <input type="checkbox"/> Isolated Land Subject to Flooding	1. square feet	
	2. cubic feet of flood storage lost	3. cubic feet replaced

f. Riverfront Area

1. Name of Waterway (if available) - **specify coastal or inland**

2. Width of Riverfront Area (check one):

25 ft. - Designated Densely Developed Areas only

100 ft. - New agricultural projects only

200 ft. - All other projects

3. Total area of Riverfront Area on the site of the proposed project: 5,859 square feet

4. Proposed alteration of the Riverfront Area:

<u>582</u>	<u>582</u>	<u>0</u>
a. total square feet	b. square feet within 100 ft.	c. square feet between 100 ft. and 200 ft.

5. Has an alternatives analysis been done and is it attached to this NOI? Yes No

6. Was the lot where the activity is proposed created prior to August 1, 1996? Yes No

3. Coastal Resource Areas: (See 310 CMR 10.25-10.35)

Note: for coastal riverfront areas, please complete **Section B.2.f.** above.



Massachusetts Department of Environmental Protection
 Bureau of Resource Protection - Wetlands

WPA Form 3 – Notice of Intent

Massachusetts Wetlands Protection Act M.G.L. c. 131, §40

Provided by MassDEP:

MassDEP File Number

Document Transaction Number

Rowley

City/Town

B. Buffer Zone & Resource Area Impacts (temporary & permanent) (cont'd)

Check all that apply below. Attach narrative and supporting documentation describing how the project will meet all performance standards for each of the resource areas altered, including standards requiring consideration of alternative project design or location.

Online Users:
 Include your document transaction number (provided on your receipt page) with all supplementary information you submit to the Department.

<u>Resource Area</u>	<u>Size of Proposed Alteration</u>	<u>Proposed Replacement (if any)</u>
a. <input type="checkbox"/> Designated Port Areas	Indicate size under Land Under the Ocean, below	
b. <input type="checkbox"/> Land Under the Ocean	_____	
	1. square feet	

	2. cubic yards dredged	
c. <input type="checkbox"/> Barrier Beach	Indicate size under Coastal Beaches and/or Coastal Dunes below	
d. <input type="checkbox"/> Coastal Beaches	_____	_____
	1. square feet	2. cubic yards beach nourishment
e. <input type="checkbox"/> Coastal Dunes	_____	_____
	1. square feet	2. cubic yards dune nourishment
	<u>Size of Proposed Alteration</u>	<u>Proposed Replacement (if any)</u>
f. <input type="checkbox"/> Coastal Banks	_____	
	1. linear feet	
g. <input type="checkbox"/> Rocky Intertidal Shores	_____	
	1. square feet	
h. <input type="checkbox"/> Salt Marshes	_____	_____
	1. square feet	2. sq ft restoration, rehab., creation
i. <input type="checkbox"/> Land Under Salt Ponds	_____	
	1. square feet	

	2. cubic yards dredged	
j. <input type="checkbox"/> Land Containing Shellfish	_____	
	1. square feet	
k. <input type="checkbox"/> Fish Runs	Indicate size under Coastal Banks, inland Bank, Land Under the Ocean, and/or inland Land Under Waterbodies and Waterways, above	

	1. cubic yards dredged	
l. <input type="checkbox"/> Land Subject to Coastal Storm Flowage	_____	
	1. square feet	

4. Restoration/Enhancement
 If the project is for the purpose of restoring or enhancing a wetland resource area in addition to the square footage that has been entered in Section B.2.b or B.3.h above, please enter the additional amount here.

_____	_____
a. square feet of BVW	b. square feet of Salt Marsh

5. Project Involves Stream Crossings

_____	_____
a. number of new stream crossings	b. number of replacement stream crossings



Massachusetts Department of Environmental Protection
Bureau of Resource Protection - Wetlands

WPA Form 3 – Notice of Intent

Massachusetts Wetlands Protection Act M.G.L. c. 131, §40

Provided by MassDEP:
MassDEP File Number
Document Transaction Number
Rowley
City/Town

C. Other Applicable Standards and Requirements

— This is a proposal for an Ecological Restoration Limited Project. Skip Section C and complete Appendix A: Ecological Restoration Limited Project Checklists – Required Actions (310 CMR 10.11).

Streamlined Massachusetts Endangered Species Act/Wetlands Protection Act Review

1. Is any portion of the proposed project located in **Estimated Habitat of Rare Wildlife** as indicated on the most recent Estimated Habitat Map of State-Listed Rare Wetland Wildlife published by the Natural Heritage and Endangered Species Program (NHESP)? To view habitat maps, see the *Massachusetts Natural Heritage Atlas* or go to http://maps.massgis.state.ma.us/PRI_EST_HAB/viewer.htm.

a. Yes No **If yes, include proof of mailing or hand delivery of NOI to:**

**Natural Heritage and Endangered Species Program
Division of Fisheries and Wildlife
1 Rabbit Hill Road
Westborough, MA 01581**

August 2021
b. Date of map

If yes, the project is also subject to Massachusetts Endangered Species Act (MESA) review (321 CMR 10.18). To qualify for a streamlined, 30-day, MESA/Wetlands Protection Act review, please complete Section C.1.c, and include requested materials with this Notice of Intent (NOI); *OR* complete Section C.2.f, if applicable. *If MESA supplemental information is not included with the NOI, by completing Section 1 of this form, the NHESP will require a separate MESA filing which may take up to 90 days to review (unless noted exceptions in Section 2 apply, see below).*

c. Submit Supplemental Information for Endangered Species Review*

1. Percentage/acreage of property to be altered:
 - (a) within wetland Resource Area _____ percentage/acreage
 - (b) outside Resource Area _____ percentage/acreage

2. Assessor's Map or right-of-way plan of site

2. Project plans for entire project site, including wetland resource areas and areas outside of wetlands jurisdiction, showing existing and proposed conditions, existing and proposed tree/vegetation clearing line, and clearly demarcated limits of work **
 - (a) Project description (including description of impacts outside of wetland resource area & buffer zone)
 - (b) Photographs representative of the site

* Some projects **not** in Estimated Habitat may be located in Priority Habitat, and require NHESP review (see <https://www.mass.gov/mas-endangered-species-act-mesa-regulatory-review>).

Priority Habitat includes habitat for state-listed plants and strictly upland species not protected by the Wetlands Protection Act.

** MESA projects may not be segmented (321 CMR 10.16). The applicant must disclose full development plans even if such plans are not required as part of the Notice of Intent process.



Massachusetts Department of Environmental Protection
Bureau of Resource Protection - Wetlands

WPA Form 3 – Notice of Intent

Massachusetts Wetlands Protection Act M.G.L. c. 131, §40

Provided by MassDEP:

MassDEP File Number

Document Transaction Number

Rowley

City/Town

C. Other Applicable Standards and Requirements (cont'd)

Online Users:

Include your document transaction number (provided on your receipt page) with all supplementary information you submit to the Department.

4. Is any portion of the proposed project within an Area of Critical Environmental Concern (ACEC)?
a. Yes No If yes, provide name of ACEC (see instructions to WPA Form 3 or MassDEP Website for ACEC locations). **Note:** electronic filers click on Website.
- b. ACEC
5. Is any portion of the proposed project within an area designated as an Outstanding Resource Water (ORW) as designated in the Massachusetts Surface Water Quality Standards, 314 CMR 4.00?
a. Yes No
6. Is any portion of the site subject to a Wetlands Restriction Order under the Inland Wetlands Restriction Act (M.G.L. c. 131, § 40A) or the Coastal Wetlands Restriction Act (M.G.L. c. 130, § 105)?
a. Yes No
7. Is this project subject to provisions of the MassDEP Stormwater Management Standards?
a. Yes. Attach a copy of the Stormwater Report as required by the Stormwater Management Standards per 310 CMR 10.05(6)(k)-(q) and check if:
1. Applying for Low Impact Development (LID) site design credits (as described in Stormwater Management Handbook Vol. 2, Chapter 3)
2. A portion of the site constitutes redevelopment
3. Proprietary BMPs are included in the Stormwater Management System.
b. No. Check why the project is exempt:
1. Single-family house
2. Emergency road repair
3. Small Residential Subdivision (less than or equal to 4 single-family houses or less than or equal to 4 units in multi-family housing project) with no discharge to Critical Areas.

D. Additional Information

- This is a proposal for an Ecological Restoration Limited Project. Skip Section D and complete Appendix A: Ecological Restoration Notice of Intent – Minimum Required Documents (310 CMR 10.12).

Applicants must include the following with this Notice of Intent (NOI). See instructions for details.

Online Users: Attach the document transaction number (provided on your receipt page) for any of the following information you submit to the Department.

1. USGS or other map of the area (along with a narrative description, if necessary) containing sufficient information for the Conservation Commission and the Department to locate the site. (Electronic filers may omit this item.)
2. Plans identifying the location of proposed activities (including activities proposed to serve as a Bordering Vegetated Wetland [BVW] replication area or other mitigating measure) relative to the boundaries of each affected resource area.



Massachusetts Department of Environmental Protection
Bureau of Resource Protection - Wetlands

WPA Form 3 – Notice of Intent

Massachusetts Wetlands Protection Act M.G.L. c. 131, §40

Provided by MassDEP:

MassDEP File Number

Document Transaction Number

Rowley

City/Town

D. Additional Information (cont'd)

- 3. Identify the method for BVW and other resource area boundary delineations (MassDEP BVW Field Data Form(s), Determination of Applicability, Order of Resource Area Delineation, etc.), and attach documentation of the methodology.
- 4. List the titles and dates for all plans and other materials submitted with this NOI.

Project Elements Plan

a. Plan Title

DeRosa Environmental Consulting, Inc. Michael DeRosa

b. Prepared By

c. Signed and Stamped by

August 1, 2022

1"=10'

d. Final Revision Date

e. Scale

f. Additional Plan or Document Title

g. Date

- 5. If there is more than one property owner, please attach a list of these property owners not listed on this form.
- 6. Attach proof of mailing for Natural Heritage and Endangered Species Program, if needed.
- 7. Attach proof of mailing for Massachusetts Division of Marine Fisheries, if needed.
- 8. Attach NOI Wetland Fee Transmittal Form
- 9. Attach Stormwater Report, if needed.

E. Fees

- 1. Fee Exempt: No filing fee shall be assessed for projects of any city, town, county, or district of the Commonwealth, federally recognized Indian tribe housing authority, municipal housing authority, or the Massachusetts Bay Transportation Authority.

Applicants must submit the following information (in addition to pages 1 and 2 of the NOI Wetland Fee Transmittal Form) to confirm fee payment:

11275	8/5/2022
2. Municipal Check Number	3. Check date
11276	8/5/2022
4. State Check Number	5. Check date
DeRosa Environmental Consulting, Inc.	
6. Payor name on check: First Name	7. Payor name on check: Last Name



Massachusetts Department of Environmental Protection
 Bureau of Resource Protection - Wetlands
NOI Wetland Fee Transmittal Form
 Massachusetts Wetlands Protection Act M.G.L. c. 131, §40

Important: When filling out forms on the computer, use only the tab key to move your cursor - do not use the return key.



A. Applicant Information

1. Location of Project:

20 Central Street

a. Street Address

11276

c. Check number

Rowley

b. City/Town

\$70

d. Fee amount

2. Applicant Mailing Address:

a. First Name

TRS Ox Brook Real Estate TRS Gerald N Fandetti, Trustee

c. Organization

350 Main Street

d. Mailing Address

Cambridge

e. City/Town

MA

f. State

02142-1017

g. Zip Code

germno@icloud.com

j. Email Address

h. Phone Number

i. Fax Number

3. Property Owner (if different):

a. First Name

b. Last Name

c. Organization

d. Mailing Address

e. City/Town

f. State

g. Zip Code

h. Phone Number

i. Fax Number

j. Email Address

B. Fees

Fee should be calculated using the following process & worksheet. **Please see Instructions before filling out worksheet.**

Step 1/Type of Activity: Describe each type of activity that will occur in wetland resource area and buffer zone.

Step 2/Number of Activities: Identify the number of each type of activity.

Step 3/Individual Activity Fee: Identify each activity fee from the six project categories listed in the instructions.

Step 4/Subtotal Activity Fee: Multiply the number of activities (identified in Step 2) times the fee per category (identified in Step 3) to reach a subtotal fee amount. Note: If any of these activities are in a Riverfront Area in addition to another Resource Area or the Buffer Zone, the fee per activity should be multiplied by 1.5 and then added to the subtotal amount.

Step 5/Total Project Fee: Determine the total project fee by adding the subtotal amounts from Step 4.

Step 6/Fee Payments: To calculate the state share of the fee, divide the total fee in half and subtract \$12.50. To calculate the city/town share of the fee, divide the total fee in half and add \$12.50.

To calculate filing fees, refer to the category fee list and examples in the instructions for filling out WPA Form 3 (Notice of Intent).

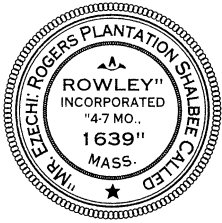

Town of Rowley Conservation Department

Town Hall Annex – Room 4
 39 Central St, P.O. Box 24, Rowley, MA 01969
 Phone: 978-948-2330 Fax: 978-948-7196
conservation@townofrowley.org

WETLAND BYLAW FEE CALCULATION FORM

Property Address:	Map:	Parcel:	Lot:
APPLICATION NAME / ACTIVITY	LOCAL BYLAW FEE	# of Activities or Measurement	Subtotal
Request for a Determination of Applicability (RDA)	\$75		
Abbrev. Notice of Resource Area Delineation (ANRAD)			
Single Family House Project	\$1/linear foot, first 100'; \$0.50/lf, second 100'; \$0.10/lf, each additional foot		
All Other Projects	*\$1/linear foot, first 1000'; \$0.50/lf, second 1000'; \$0.10/lf, each additional foot		
Notices of Intent (NOI)			
Category 1 Activity	\$100	1	\$100
Category 2 Activity	\$250		
Category 3 Activity	\$525		
Category 4 Activity	\$725		
Category 5 Activity	\$2/foot		
Category 6 Activity - If no ANRAD was filed for the project site, then a local Cat. 6 fee must be paid in accordance with the ANRAD fee schedule	See ANRAD fee schedule		
Request to Amend an OOC (RAOC)	\$100		
Resource Area Alterations (for NOI & RAOC)			
Buffer Zone, 50'-100' from resource area boundary	\$0.05 / square foot		
Buffer Zone, 25'-50' from resource area boundary	\$0.10 / square foot	42	\$4.20
Buffer Zone, 0'-25' from resource area boundary	\$0.25 / square foot	540	\$135
Bordering Vegetated Wetlands & Salt Marsh Bank	\$0.35 / square foot		
Land Under Water & Waterways	\$0.35 / square foot		
Bordering Land Subject to Flooding & CLSSF**	\$0.05 / square foot		
***Riverfront Area only	\$0.05 / square foot		
Isolated Vegetated Wetlands	\$0.35 / square foot		
Land within Groundwater Protection Area Zone I	\$0.25 / square foot		
Land within Groundwater Protection Area Zone II	\$0.05 / square foot		
Other Local-only Jurisdictional Resource Areas	\$0.05 / square foot		
Extension Permit	\$100		
Certificate of Compliance	Projects under one acre in size: \$100 - over an acre in size \$250		
For filings resulting from enforcement action, double the Local Bylaw Fee Total			\$239.20x2=\$478.40
LOCAL BYLAW FEE TOTAL			\$717.60
As Determined by the Commission, Fee Total not to exceed \$15,000 except Enforcement			
NOTES:			
*Local Bylaw Fee maximum of \$100, if, when determined necessary by Commission, applicant agrees to ANRAD review by outside consultant under M.G.L. Ch. 44, sec. 53G			
**Coastal Land Subject to Storm Flowage			
***Local Bylaw Fees for RDA, NOI, & RAOC increase 50% when project is also proposed within a Riverfront Area			
Local Bylaw Fees passed by a Unanimous vote of the Commission on 10/1/2019, effective 10/2/2019			

INSTITUTION FOR SAVINGS

11275

53-7094/2113

04

CHECK ARMOR

TRADE PROTECTION

8/5/2022

DEROSA ENVIRONMENTAL CONSULTING, INC

PO BOX 716
167 MAIN STREET
ROWLEY, MA 01969

PAY TO THE ORDER OF

Town of Rowley

\$ 807.60

Eight hundred seven and $\frac{60}{100}$

DOLLARS

MEMO

20 Central St Rowley -MSI



[Handwritten Signature]
AUTHORIZED SIGNATURE



INSTITUTION FOR SAVINGS

11276

53-7094/2113

04

CHECK ARMOR

TRADE PROTECTION

8/5/2022

DEROSA ENVIRONMENTAL CONSULTING, INC

PO BOX 716
167 MAIN STREET
ROWLEY, MA 01969

PAY TO THE ORDER OF

Commonwealth of Massachusetts

\$ 70.00

Seventy and $\frac{00}{100}$

DOLLARS

MEMO

20 Central St. Rowley -MSI



[Handwritten Signature]
AUTHORIZED SIGNATURE



Details on Back. Security Features Included

Details on Back. Security Features Included

Appendix A

Abutters List

Abutter Notification Letter

CERTIFIED ABUTTERS' LIST

Parcel ID	Location	Owner Name/Address
025-007	20 CENTRAL ST	TRS OX BROOK REAL ESTATE TRS FANDETTI GERALD N TRUSTEE 350 MAIN ST CAMBRIDGE, MA 02142-1017
----- A B U T T E R S -----		
024-135	23 CENTRAL ST	BEGLEY MICHAEL JOHN BEGLEY LURDE JOSEFINA PO BOX 681 ROWLEY, MA 01969
024-136-01	15 CHURCH ST 01	HARTLEY CLAUDIA 15 CHURCH ST ROWLEY, MA 01969
024-136-01-5	11-15 CHURCH ST MASTER CARD	BRM REALTY LLC 69 PEARSON ST BYFIELD, MA 01922
024-136-02	11 CHURCH ST 02	SHAW SEAN ERIC CATTO MCKAYLA J 11 CHURCH ST ROWLEY, MA 01969
025-004	10 CENTRAL ST	COOK MICHAEL L SR COOK LINDA A PO BOX 197 ROWLEY, MA 01969
025-005	14 CENTRAL ST	MAKER FLOYD A JR MAKER PAMELA E 14 CENTRAL ST ROWLEY, MA 01969
025-006	16 CENTRAL ST	BELL VERNON J III PO BOX 93 ROWLEY, MA 01969
025-008	28 CENTRAL ST	TRS 28 CENTRAL ST TRUST C/O RICHARD MACDONALD 52 SUMMER ST ROWLEY, MA 01969
025-009	34 CENTRAL ST	TRS 34 CENTRAL ST REALTY TRUST MORSE DONALD ROBERT ET AL TRUST PO BOX 386 BEVERLY, MA 01915

Date: 07/26/2022
txaabut

Town of Rowley

CERTIFIED ABUTTERS' LIST

Parcel ID	Location	Owner Name/Address
025-007	20 CENTRAL ST	TRS OX BROOK REAL ESTATE TRS FANDETTI GERALD N TRUSTEE 350 MAIN ST CAMBRIDGE, MA 02142-1017

A B U T T E R S

025-031	13 CENTRAL ST	TUFF JOSHUA W TUFF MATTHEW W 13 CENTRAL ST ROWLEY, MA 01969
---------	---------------	--

10 parcels listed

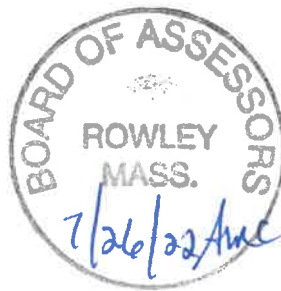

Sean McFadden
Principal Assessor

Town of Rowley

07/26/2022

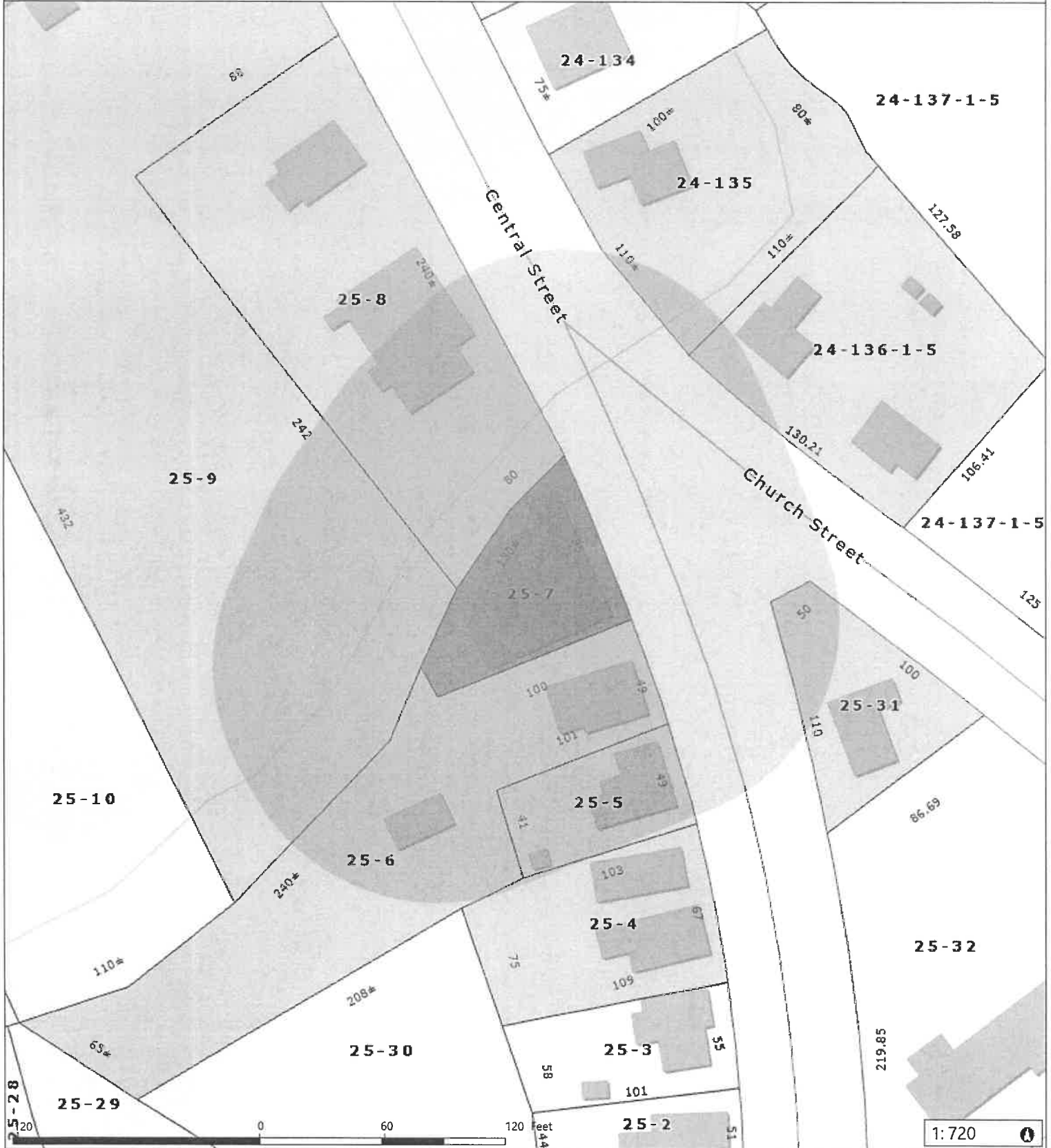

Data Sources: Produced by Merrimack Valley Planning Commission (MVPC) using data provided by the Town of Rowley & MassIT/MassGIS.
MVPC AND THE TOWN OF ROWLEY MAKES NO WARRANTIES, EXPRESSED OR IMPLIED, CONCERNING THE ACCURACY, COMPLETENESS, RELIABILITY, OR SUITABILITY OF THESE DATA. THE TOWN OF ROWLEY AND MVPC DOES NOT ASSUME ANY LIABILITY ASSOCIATED WITH THE USE OR MISUSE OF THIS INFORMATION



- | | | | | | | | | | |
|--------------------|---------------------|-------|-----------------------|------------|---------|---------------|------------|------------|---------|
| Municipal Boundary | Building Footprints | Roads | Hydrographic Features | Interstate | Streams | Legend | Major Road | Local Road | Parcels |
|--------------------|---------------------|-------|-----------------------|------------|---------|---------------|------------|------------|---------|

**Notification to Abutters Under the
Massachusetts Wetlands Protection Act and
The Town of Rowley Wetlands Protection Bylaw**

In accordance with the second paragraph of Massachusetts General Laws Chapter 131, Section 40 and the Town of Rowley Wetlands Protection Bylaw, you are hereby notified of the following:

A. The name of the applicant is TRS Ox Brook Real Estate TRS Gerald N Fandetti, Trustee
350 Main Street, Cambridge, MA 02142-1017
(name & address)

B: The applicant has filed a(n) Notice of Intent with the Rowley
(permit type)

Conservation Commission seeking to:

Description of Project: _____

Proposed construction of a patio, implementation of a Restoration Plan and
after the fact alteration within the buffer zone to inland bank

_____ in accordance with the Wetlands Protection Act (Mass.General Laws, Chapter 131, section 40) and the Town of Rowley Wetlands Protection Bylaw.

C. The address of the lot where the activity is proposed is 20 Central Street
Map 25, Parcel _____, Lot 7.

D. Copies of the application may be examined or obtained at the Rowley Conservation Commission office, Rowley Town Hall Annex, 39 Central Street, Rowley between the hours of 9:00 AM to 12:30 PM on Monday to Thursday. For more information please call 978 948-2330.

E. Copies of the application may also be examined or obtained from either the applicant, or the applicant's representative, by calling this telephone number 978-948-7717 * between the hours of 9 and 4 on the following days of the week: **M T W Th F.**

*Circle One: This is the applicant, **representative**, or other (specify): _____
(name & address)

F. Information regarding the date, time, and place of the public hearing may be obtained from the Rowley Conservation Commission by calling this number 978 948-2330.

Note: Notice of the public hearing, including its date, time, and place, will be published at least five (5) days in advance in the Newburyport Daily News.

Note: Notice of the public hearing, including its date, time, and place, will be posted in the Town Hall 139 Main Street, Rowley, MA not less than forty-eight (48) hours in advance.

Note: You also may contact your local Conservation Commission or the nearest Department of Environmental Protection Regional Office for more information about this application or the Wetlands Protection Act. To contact DEP, call: **Northeast Regional Office 978 694-3200** or write **DEP NERO 205B Lowell Street, Wilmington, MA 01887**

Appendix B

Professional Qualifications

Abigail Manzi

Evin Guvendiren

Michael J. DeRosa



Evin Guvendiren, BS

Natural Resource Economist

Evin graduated from the University of Massachusetts Amherst with a Bachelor of Science in Natural Resource Economics and minors in Environmental Science, Economics, and Natural Resource Conservation. Her studies focused on sustainability, econometrics, land conservation, environmental policy and natural resource management.

Evin joined DeRosa Environmental Consulting in the Summer of 2017 and is currently holding the position as Environmental Scientist.

During her bachelor's studies, Evin spent a semester abroad with the School for Field Studies in Costa Rica. There, she lived on a sustainable farm and implemented an integrated pest management system. Her classes consisted of field experience and course work on sustainable development, tropical ecology, and resource management in a developing country. She also participated in environmental stewardship and spent one month conducting a Socio-economic directed research project with a national park.

Evin also spent a semester researching the Colony Collapse Disorder as an independent study. She helped a professor with a grant from the USDA to determine consumers' willingness to pay for native bee pollination on cranberries. This research was funded to help find an alternative to commercial honeybee pollination to support the agriculture industry and economy.

Having grown up near beaches and ocean, marshes, rivers, vernal pools, and national parks, Evin has a strong love and passion for the environment. She spends most of her time outdoors and camps, hikes and kayaks whenever she can.

EDUCATION

BS, Natural Resource Economics | 2014
University of Massachusetts, Amherst, MA

PROFESSIONAL EXPERIENCE

Environmental Scientist | 2017 – Present

DeRosa Environmental Consulting Inc

Student Researcher | January – May 2014

University of Massachusetts Amherst-Resource Economics department

Student Researcher | January – May 2013

The SFS Center for Sustainable Development Studies, Atenas, Costa Rica

REPRESENTATIVE PROJECTS

**Private Residence | Dune Grass
Restoration**
Manchester, MA

**Commercial Property | Wetland
Restoration**
Rowley, MA

**Private Residence | Reconstruction of a
Single Family Home**
Ipswich, MA

**Invasive Plant Management |
Restoration Project**
Ipswich, MA

**Sally's Meadow | Butterfly Meadow
Restoration**
Ipswich, MA



REPRESENTATIVE PROJECTS

Private Residence | Dune Grass Restoration
Manchester, MA

Commercial Property | Wetland Restoration
Rowley, MA

Willowdale State Forest | Culvert Repair
Ipswich, MA

Saint Joseph's School | Well Monitoring
Salem, MA

Private Residence | Reconstruction of a Single Family Home
Ipswich, MA

Ipswich River Watershed Association | River Culvert Survey
North Shore, MA

Invasive Plant Management | Restoration Project
Ipswich, MA

Sally's Pond | Trail Restoration Grant
Ipswich, MA

Abigail Manzi, BA

Environmental Scientist

Abby graduated with a bachelor's degree in Environmental Studies and Biology from Guilford College in Greensboro, North Carolina. Her studies focused on sustainable practices and ecology with courses including Sustainable Business, Animal Behavior, Rainforest Ecology and Environmental Policy.

Abby joined DeRosa Environmental Consulting in the fall of 2015. She is currently working at DeRosa Environmental as an Environmental Scientist.

While in college Abby spent a semester abroad in the rainforest in Australia studying Rainforest Ecology, Forestry Management and Socioeconomics. She also spent a month of her time there researching Lumholtz's Tree Kangaroos.

Prior to working at DeRosa Environmental Abby traveled to Hawaii to work on farms and learn about organic farming practices through World Wide Opportunities on Organic Farms (WWOOF).

Abby grew up with a love for the wildlife and nature taking trips every spring out to the vernal pools with her mom to check out the amphibians and camping every summer. She loves anything outdoors including hiking, diving, snowboarding and swimming. She travels as much as possible, especially to new places with animals she has never seen.

EDUCATION

BA, Biology and Environmental Studies | 2014
Guilford College, Greensboro, NC

PROFESSIONAL EXPERIENCE

Environmental Scientist | 2015 – Present
DeRosa Environmental Consulting Inc
Intern | Summer 2013
Ipswich River Watershed Association

Student Researcher | August-December 2012
Center for Rainforest Studies, Queensland, Australia

PROFESSIONAL MEMBERSHIPS/AFFILIATIONS

AMWS | Association of Massachusetts Wetland Scientists

CERTIFICATION

40 Hour Hazardous Waste Site Worker (OSHA)

PADI Open Water Diver | 2015

Adult First Aid/CPR/AED | Exp. 8/7/2020

LICENSE

Unmanned Aircraft License | FAA | Exp. 2/19/2021



Michael J. DeRosa

Principal, LSP, LEED AP BC&D

Michael J. DeRosa, Principal and project manager specializing in habitat restoration and wetland restoration projects. He has more than 24 years experience working with ecological systems focused on restoration and rehabilitation of damaged landscapes. Ecological principles inform his design and restoration practices.

Mike was the principal wetland permitting leader for the Turner Hill Resort Center in Ipswich Massachusetts. He has consulted with the Archdiocese of Boston since 1989 in all environmental areas. His firm is known for their expertise in wetland and wildlife habitat restoration and rehabilitation and invasive species control and management.

Mike incorporated DeRosa Environmental Consulting, Inc., in May 1994 after spending 8 years working in the environmental consulting industry as technical director and project manager. Prior to his consulting career he was a researcher at the Harvard School of Tropical Public Health working with infectious diseases and tick transmitted Lyme disease, in particular.

Mike has been involved with many projects associated with MGL Ch. 21e and Massachusetts Contingency Plan (MCP) projects. He received his Licensed Site Professional (LSP Lic. 3452) registration in 1993. Mike is uniquely credentialed in hazardous waste site assessment and remediation and has over 24 years experience in wetland permitting, habitat restoration and mitigation. Mike has permitted projects with all federal, state and local environmental agencies. Mike is on the Practice Faculty at The Boston Architectural College. His new passion is the incorporation of urban agriculture and food justice initiatives in mixed use community based projects.

EDUCATION

MA, Boston University, 1993

North Carolina State University, 1986

Harvard University, 1985

BA, University of Denver, 1982

REPRESENTATIVE PROJECTS

Ipswich River Watershed Association
Ipswich MA

**Miles River Task Force |
Watershed Restoration**
Beverly Wenham Hamilton Ipswich MA

**Paumier Residence |
Dune Restoration**
Manchester MA

**Matignon High School Athletic Fields |
Landfill Cap Remediation**
Cambridge/Somerville MA

**Turner Hill Golf Course |
Wetland Mitigation & Pond Design**
Ipswich MA

**Saint Aidan's Church |
UST Remediation**
Brookline MA

**Saint Kevin's School |
AST Remediation**
Dorchester MA

**Saint Joseph's School |
UST Remediation**
Salem MA

**Ipswich Country Club |
Wetland Restoration**
Ipswich MA

**Ould Newbury Golf Club |
LID Runoff Design**
Newbury MA

**Ferncroft Country Club |
Pond Restoration**
Topsfield/Middleton MA

PROFESSIONAL EXPERIENCES

Principal, LSP, LEED AP BC&D

DeRosa Environmental Consulting, Inc. | 1994-Present

Technical director, Environmental Engineering Division

Web Engineering Associates, Inc. | 1990-1994

Project manager/Environmental Scientist,

Dennison Environmental, Inc. | 1988-1989

Population Ecologist & Wetlands Specialist,

Lelito Environmental Consultants, LLC | 1987-1988

Research Assistant,

North Carolina State University | 1985-1987

Air Pollution Analyst

Entropy Environmentalists, Inc. | 1985-1987

Senior Research Assistant

Harvard University | 1983-1985

Naturalist

The Trustees of Reservations | 1983-1985

PROFESSIONAL MEMBERSHIPS/AFFILIATIONS

New England Wildflower Society

USGBC | United States Green Building Council

NGWA | National Ground Water Association

AMWS | Association of Massachusetts Wetland Scientists

LSPA | Licensed Site Professional Association

SWS | Society of Wetland Scientists

MACC | Massachusetts Association of Conversation Commissioners

CERTIFICATIONS AND SPECIAL TRAINING

Licensed Site Professional (LSP), Lic. No. 3452

Professional Wetland Scientist (PWS)

LEED Accredited Professional | 10342989

Certified Ecologist, The Ecological Society of America |

June 2002 – May 2007

CERCLA 40 Hour Hazardous Materials Safety Training |

OSHA 29 CFR 1910.120

Confined Space Entry Training | OSHA 29 CFR 1910.146

Management Training Workshop | Dun and Bradstreet

Hazardous Materials Chemistry Seminar | University of Toledo

Unmanned Aircraft License | FAA | Exp. 2/28/2019